

Sådan er Kee Klamp skruet sammen

Det er altid de enkle løsninger, der holder længst. Det er Kee Klamp systemet det bedste bevis på. Enkelt, gennemført og utrolig anvendeligt har det gået sin sejrsgang over det meste af verden.

Kee Klamp fittings er udviklet i England og bygger på den slående nærliggende filosofi, at man de fleste steder har adgang til rør og kan løse de fleste konstruktionsopgaver, hvis man blot får rørene samlet, så de fremstår som en samlet forsvarlig enhed.

Det er præcis dét, som Kee Klamp gør. Her er det manglende led, der får utallige løsninger op at stå i ordets bogstaveligste forstand. Vel at mærke så solidt, at konstruktionen holder til de belastninger, der var forudsætningerne fra starten.



Nøglen har alle lige ved hånden

Kee Klamp fittings findes i alle tænkelige variationer. Samlinger, hjørner, led og kryds. Det er næsten umuligt at finde en vinkel, hvor systemet ikke kan få samling på rørene.

Når de nødvendige fittings er på plads, sker selve samlingen tilmed uhyre enkelt ved hjælp af en ganske almindelig unbrako nøgle.

Det sikrer på den ene side, at samlingen holder og på den anden side, at man hurtigt og nemt kan foretage ændringer.

Et system i stadig udvikling

Gennem årene er Kee Klamp løbende blevet suppleret med nye muligheder og variationer. Der kommer konstant komponenter til, der udvider systemets anvendelsesmuligheder.

Netop fremtidssikringen spiller en væsentlig rolle, når man beslutter sig for at bruge Kee Klamp, for det vil altid være muligt at forfine og ændre konstruktionen. Har man valgt Kee Klamp får man frie hænder til fremtidige forbedringer, som tilbygninger, ny indretning, større belastninger. En Kee Klamp investering er et aktiv og indeholder al den fleksibilitet man kan ønske sig.

Åben for specielle ønsker

Fra klatrestativet på legepladsen til den sikre platform til udstillingsbilen. Fra solide rækværk til sikre og stærke gelændere. Fra konfektions- og lagerstativer til stabile rækværk og cykelstativer.

Det er umuligt at sætte Kee Klamp i bås, for kun fantasien sætter grænser for anvendelsen. Kee Klamp leveres sågar galvaniseret og malet, hvis det er nødvendigt til opgaven.

Læs mere om Kee Klamp i kataloget her - og kontakt os med din ønsker.

Her finder du os

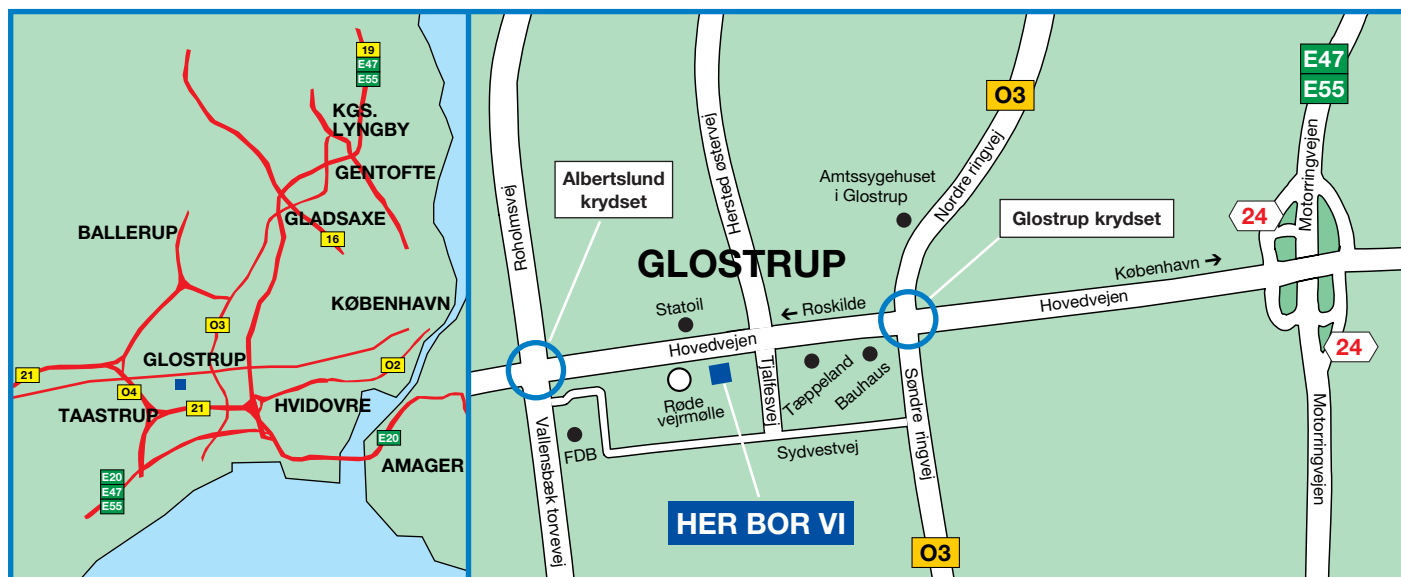

Kee Klamp sætter standarden

Kee Klamp systemet er testet og godkendt af det tyske testinstitut TÜV, der er almindeligt anerkendt, som et af de mest kompetente i Europa. Testmetoden er på vej til at blive en anerkendt norm i hele EU.



**KEE KLAMP LTD.
IS AN ISO 9001 QUALITY
ASSURED COMPANY**





Kee Klamp fittings og rør

Find den ønskede dimension

Kee Klamp fittings fås i flere størrelser, så de passer til galvaniserede rør i otte forskellige dimensioner. På den måde er det altid muligt at finde en velegnet løsning til opgaven. Fra den tynde, elegante størrelse 2 over de mere almindelige dimensioner til størrelse 9, der kan holde selv den største konstruktion stabil og sikker. Spændvidden i systemet sikrer valgfrihed og fleksibilitet.

Til højre gengiver vi rørdimensionerne i størrelse 1:1, så du kan danne dig et indtryk af mulighederne. I skemaet herunder kan du finde rørenes diameter i såvel mm. som tommer.

GALVANISEREDE RØR			
Rør til Kee Klamps leveres i fabrikkations længder á 6 m, eller på mål efter ønske. Til dagspris.			
Kee Klamp nummer	Udv. diam. i mm	Indv.diam. tommer	Godstykkeelse i mm
2	12,00	Rundjern	
3	17,20	3/8	2,35
4	21,30	1/2	2,65
5	26,90	3/4	2,65
6	33,70	1	3,20
7	42,40	1 1/4	3,20
8	48,30	1 1/2	3,20
9	60,30	2	3,60

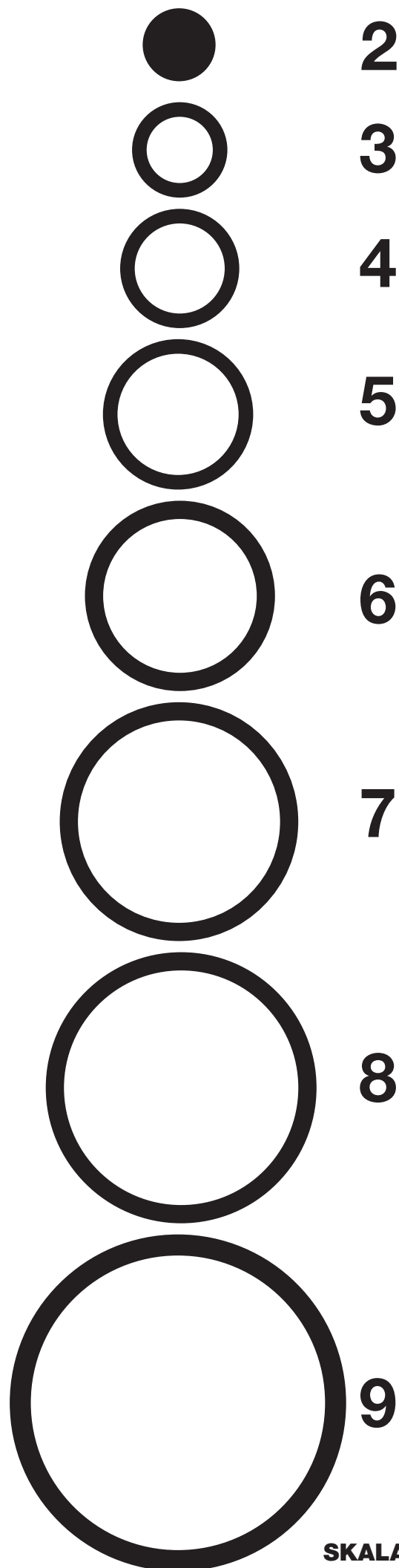

SKALA 1:1

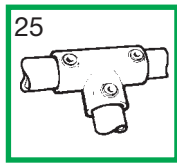

Bukket rør

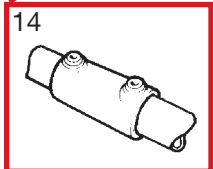
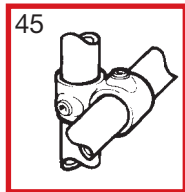
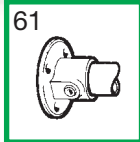
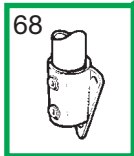
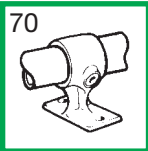

TYPE	A	B	C	D	E	F	G	H	Ø	KG
10-2	2	2		25						0,02
10-3	3	3		29						0,07
10-4	4	4		34						0,13
10-5	5	5		41						0,23
10-6	6	6		46						0,29
10-65	6	5		44						0,25
10-67	6	7		55						0,43
10-7	7	7		60						0,45
10-75	7	5		59						0,32
10-76	7	6		57						0,43
10-78	7	8		73						0,63
10-8	8	8		68						0,62
10-87	8	7		64						0,50
10-9	9	9		85						0,97
10-98	9	8		74						0,65

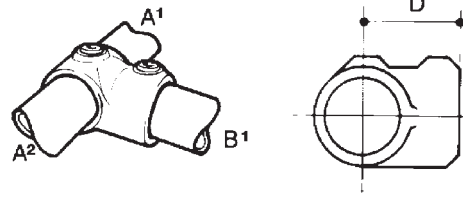

10

TYPE	A	B	C	D	E	F	G	H	Ø	KG
12-5	5			37	72					0,30
12-6	6			44	85					0,43
12-7	7			55	102					0,71
12-8	8			65	123					0,92

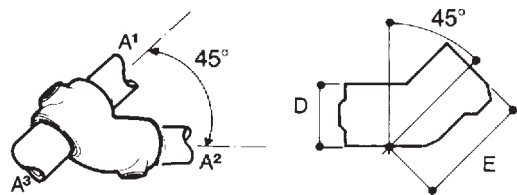

12

TYPE	A	B	C	D	E	F	G	H	Ø	KG
14-4	4				58					0,14
14-5	5				77					0,27
14-6	6				89					0,39
14-7	7				102					0,52
14-8	8				104					0,64
14-9	9				124					1,08

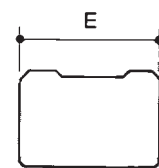
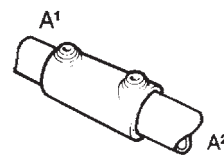

14

TYPE	A	B	C	D	E	F	G	H	Ø	KG
15-4	4			34						0,13
15-5	5			41						0,27
15-6	6			46						0,37
15-7	7			60						0,67
15-8	8			68						0,77
15-9	9			85						1,28

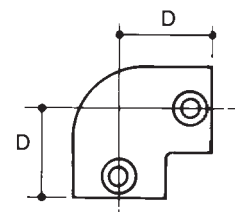
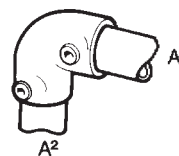

15

TYPE	A	B	C	D	E	F	G	H	Ø	KG
16-5	5			50		Bolt 10x45				0,29
16-6	6			52		Bolt 10x50				0,33
16-7	7			68		Bolt 10x60				0,59
16-8	8			73		Bolt 10x60				0,60
16-9	9			90		Bolt 10x70				0,92

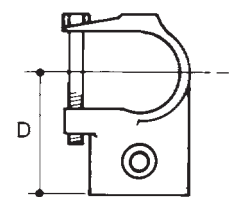
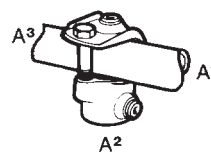

16

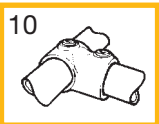
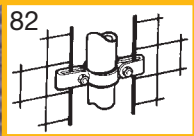
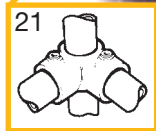
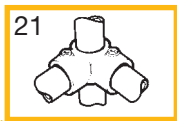
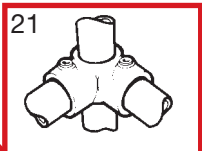
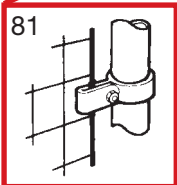
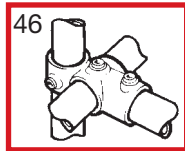

TYPE	A	B	C	D	E	F	G	H	Ø	KG
17-5	5	5		27	41					0,15
17-6	6	6		34	48					0,23
17-7	7	7		43	63					0,43
17-78	7	8								0,49
17-8	8	8		49	68					0,56
17-9	9	9		61	78					0,90

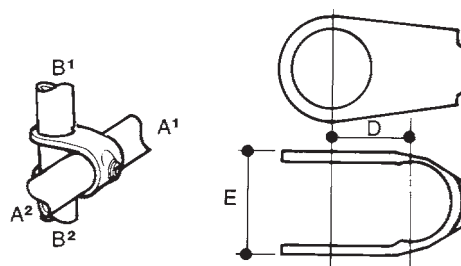

17

TYPE	A	B	C	D	E	F	G	H	Ø	KG
18-6	6			76	20					0,26
18-7	7			76	20					0,38
18-8	8			95	20					0,54

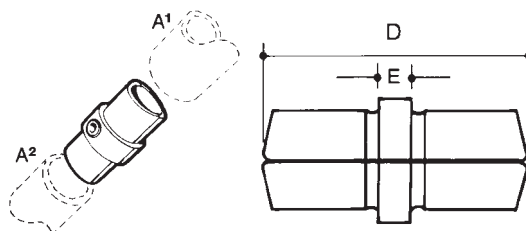

18

TYPE	A	B	C	D	E	F	G	H	Ø	KG
19-5	5	5		60	-31					0,20
19-6	6	6		58	-33					0,29
19-7	7	7		73	-40					0,41
19-8	8	8		90	-55					0,53
19-85	8	5		73	-45					0,65
19-9	9	9		110	-49					0,99

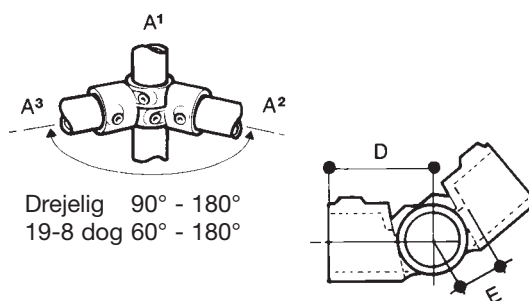

19

Bruges parvis - sælges enkeltvis.

TYPE	A	B	C	D	E	F	G	H	Ø	KG
20-4	4			34						0,17
20-5	5			41						0,38
20-6	6			46						0,48
20-7	7			60						0,81
20-8	8			68						1,13
20-9	9			85						1,82

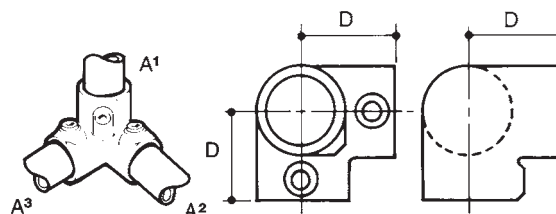

20

TYPE	A	B	C	D	E	F	G	H	Ø	KG
21-4	4			34						0,14
21-5	5			41						0,28
21-6	6			46						0,41
21-7	7			60						0,69
21-8	8			68						0,85
21-9	9			85						1,36

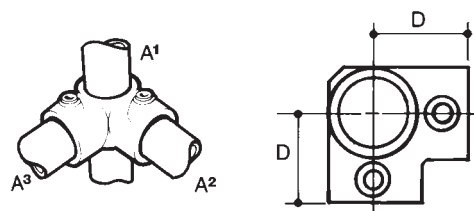

21

TYPE	A	B	C	D	E	F	G	H	Ø	KG
25-4	4			34	68					0,18
25-5	5			41	82					0,37
25-6	6			46	92					0,49
25-7	7			60	120					0,85
25-8	8			68	136					1,09
25-9	9			85	168					1,74

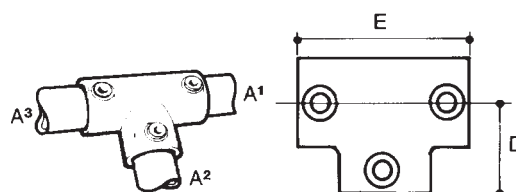

25

68



45

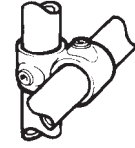

62

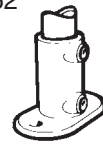

46

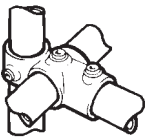

62

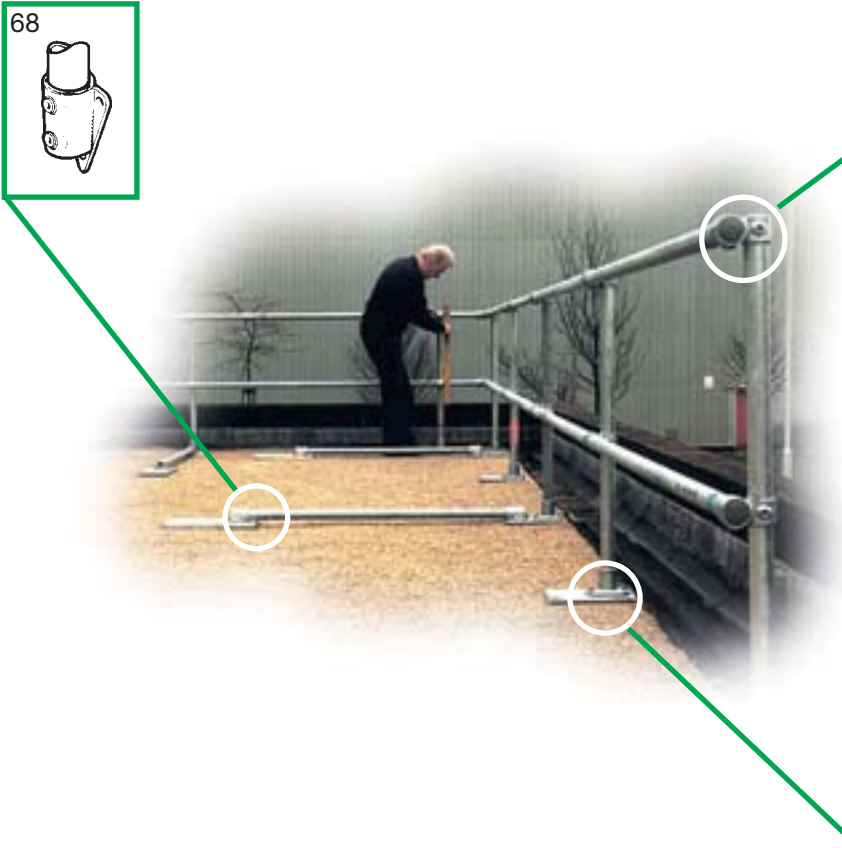
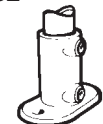

TYPE	A	B	C	D	E	F	G	H	Ø	KG
26-3	3	3			57					0,12
26-4	4	4			68					0,13
26-5	5	5			82					0,27
26-6	6	6			92					0,40
26-7	7	7			120					0,65
26-8	8	8			136					0,85
26-87	8	7			126					0,63
26-9	9	9			168					1,46

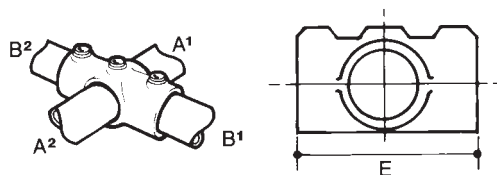

26

TYPE	A	B	C	D	E	F	G	H	Ø	KG
29-6	6			82	64					0,44
29-7	7			93	74					0,63
29-8	8			102	68					0,97

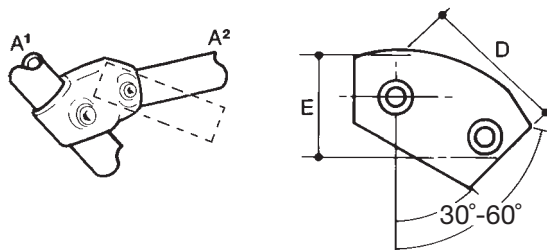

29

TYPE	A	B	C	D	E	F	G	H	Ø	KG
30-6	6				146					0,64
30-7	7				178					0,97
30-8	8				216					1,30

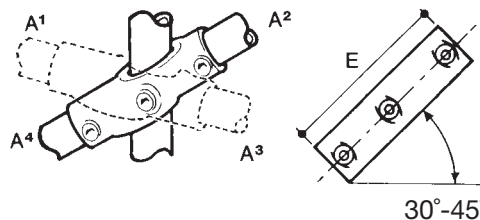

30

TYPE	A	B	C	D	E	F	G	H	Ø	KG
35-4	4			34	68					0,20
35-5	5			41	82					0,35
35-6	6			46	92					0,45
35-7	7			60	120					0,77
35-8	8			68	136					1,19
35-9	9			85	168					1,83

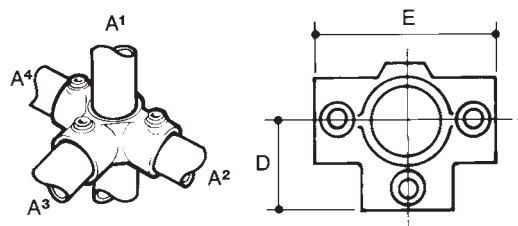

35

TYPE	A	B	C	D	E	F	G	H	Ø	KG
40-4	4			33	67					0,20
40-5	5			32	82					0,51
40-6	6			37	92					0,60
40-7	7			46	120					1,05
40-8	8			53	136					1,46
40-9	9			62	168					2,30

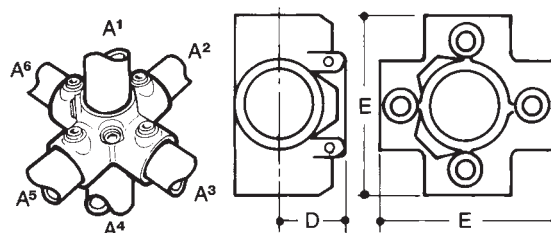

40

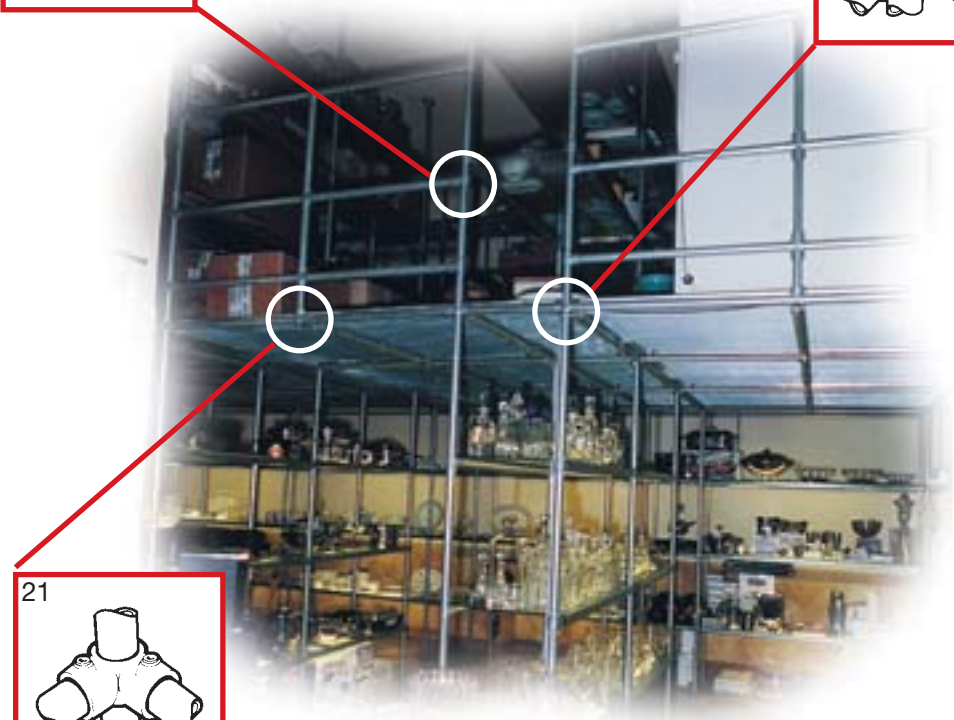
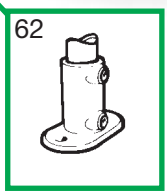
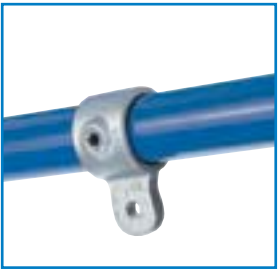
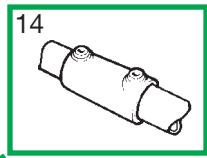
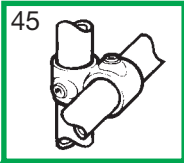
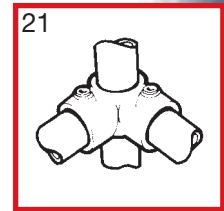
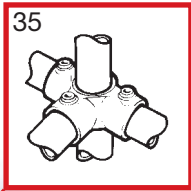
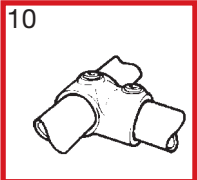

TYPE	A	B	C	D	E	F	G	H	Ø	KG
45-2	2	2			19	16				0,02
45-3	3	3			24	21				0,07
45-4	4	4			28	25				0,13
45-5	5	5			31	34				0,23
45-6	6	6			38	40				0,29
45-65	6	5			43/37	36				0,25
45-7	7	7			46	49				0,43
45-76	7	6			46/38	45				0,45
45-8	8	8			51	55				0,32
45-86	8	6			51/38	48				0,43
45-87	8	7			51/46	51				0,62
45-9	9	9			61	67				0,50
45-98	9	8			76/76	60				0,97

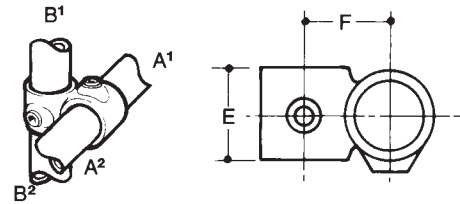

45

TYPE	A	B	C	D	E	F	G	H	Ø	KG
46-4	4	4	4	34	28	25				0,15
46-5	5	5	5	41	31	34				0,30
46-6	6	6	6	46	38	40				0,49
46-7	7	7	7	60	46	49				0,69
46-8	8	8	8	68	51	55				0,91
46-9	9	9	9	85	61	67				1,54

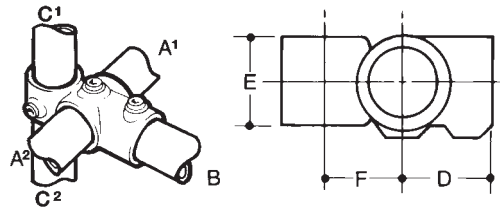

46

TYPE	A	B	C	D	E	F	G	H	Ø	KG
F50-4	4			36	14	11			6,5	0,07
F50-5	5			60	25	19			10	0,28
F50-6	6			60	25	19			10	0,34
F50-7	7			68	25	19			10	0,42
F50-8	8			76	25	19			10	0,52
F50-9	9			85	26	19			10	0,65

Afstand mellem lapper: 13 mm.

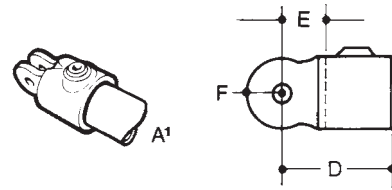

F50

TYPE	A	B	C	D	E	F	G	H	Ø	KG
M50-3	3			24	19	11			6,5	0,06
M50-4	4			26	20	11			6,5	0,06
M50-5	5			40	40	19			10	0,24
M50-6	6			43	40	19			10	0,27
M50-7	7			48	47	19			10	0,36
M50-8	8			54	47	19			10	0,36
M50-9	9			62	52	19			10	0,54

Godstykkelse på lap: 12 mm.

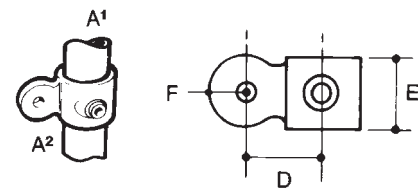

M50

TYPE	A	B	C	D	E	F	G	H	Ø	KG
C50-44	4									0,15
C50-55	5									0,56
C50-66	6									0,64
C50-77	7									0,80
C50-88	8									0,91
C50-99	9									1,22

Reducering kan foretages i størrelserne 5-9

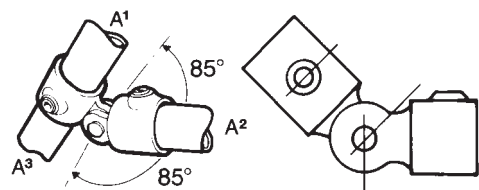

C50

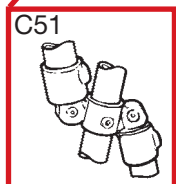
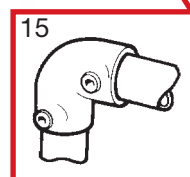
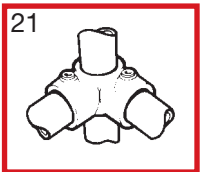
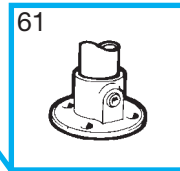
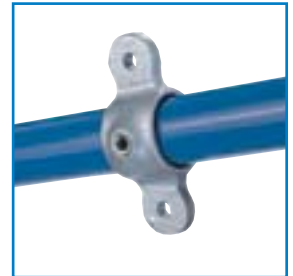
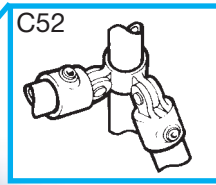
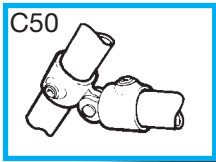

TYPE	A	B	C	D	E	F	G	H	Ø	KG
P50-8	8			61	80	47	32	8		0,48

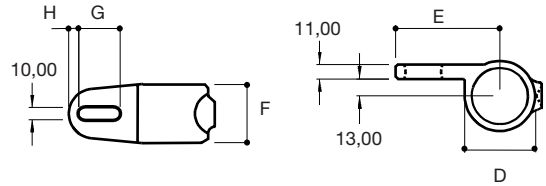

P50

TYPE	A	B	C	D	E	F	G	H	Ø	KG
MH50-6	6	46	38	11	43	38			10	0,34

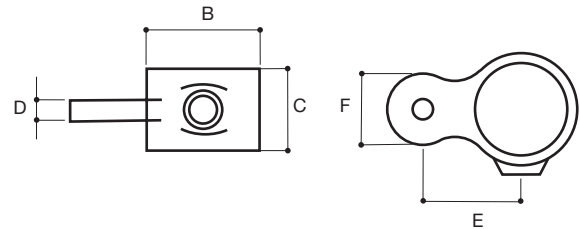

MH50

TYPE	A	B	C	D	E	F	G	H	Ø	KG
M51-5	5			40	40	19			10	0,33
M51-6	6			43	40	19			10	0,38
M51-7	7			48	47	19			10	0,46
M51-8	8			54	47	19			10	0,48
M51-9	9			62	52	19			10	0,71

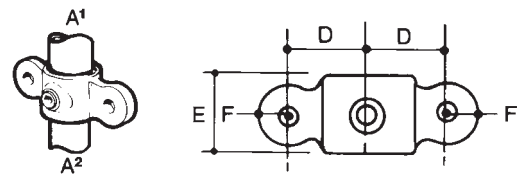

M51

Godstykkelese på lap: 12 mm.

TYPE	A	B	C	D	E	F	G	H	Ø	KG
C51-555	5									0,99
C51-666	6									1,11
C51-777	7									1,35
C51-888	8									1,57
C51-999	9									2,06

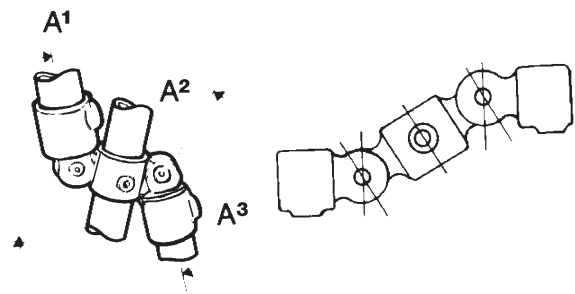

C51

Reducering kan foretages i størrelserne 5-9

TYPE	A	B	C	D	E	F	G	H	Ø	KG
P51-8	8			61	81	47	32	8		0,70

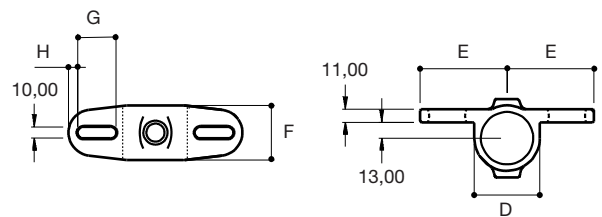

P51

TYPE	A	B	C	D	E	F	G	H	Ø	KG
MH51-6	6	46	38	11	43	38			10	0,44

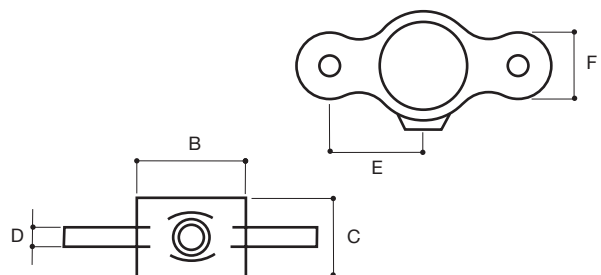

MH51

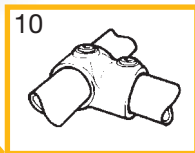
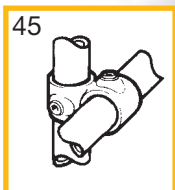
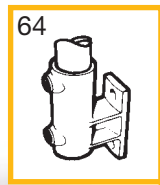
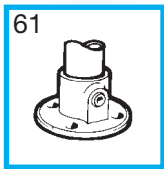
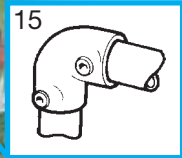
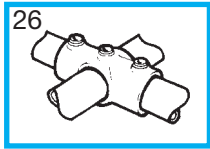
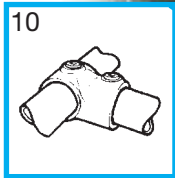

TYPE	A	B	C	D	E	F	G	H	Ø	KG
M52-5	5			40	40	19			10	0,36
M52-6	6			43	40	19			10	0,39
M52-7	7			48	47	19			10	0,45
M52-8	8			54	47	19			10	0,46

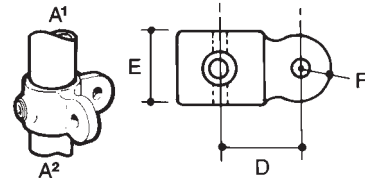

M52

Godstykkelse på lap: 12 mm.

TYPE	A	B	C	D	E	F	G	H	Ø	KG
C52-555	5									0,97
C52-666	6									1,12
C52-777	7									1,34
C52-888	8									1,55

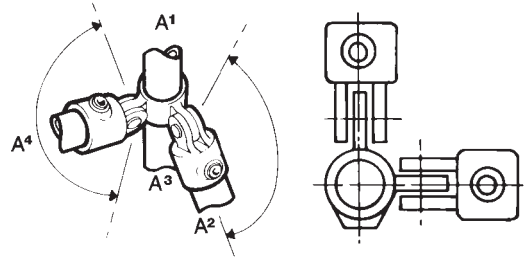

C52

Reducering kan foretages i størrelserne 5-9

TYPE	A	B	C	D	E	F	G	H	Ø	KG
BC53-8	8			85	45					1,82

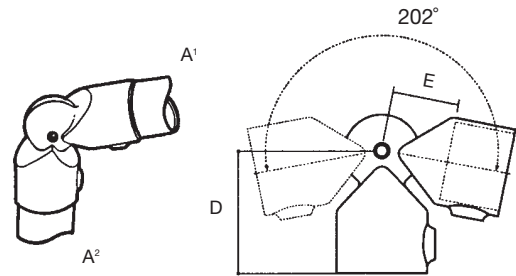

BC53

TYPE	A	B	C	D	E	F	G	H	Ø	KG
55-6	6					46				0,51
55-7	7					55				0,81
55-8	8					60				0,85

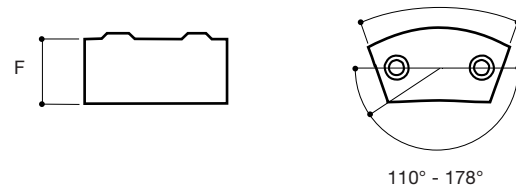
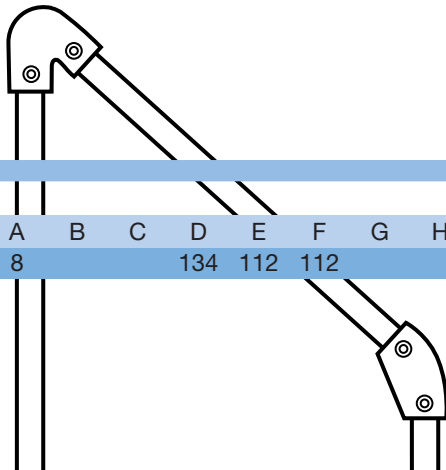

55

TYPE	A	B	C	D	E	F	G	H	Ø	KG
56-8	8			134	112	112				1,45

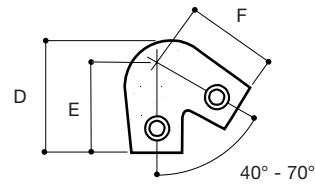

56

TYPE	A	B	C	D	E	F	G	H	Ø	KG
P57-7										
P57-8	8			61	77,5	32	22,5	9		1,54

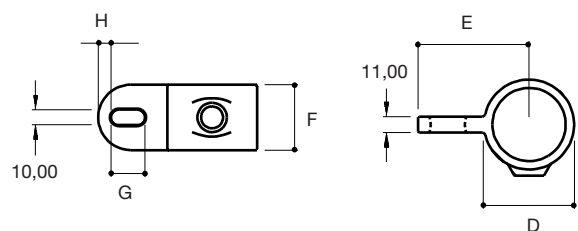

P57

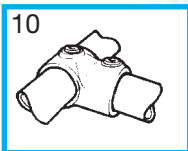
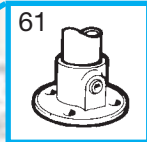
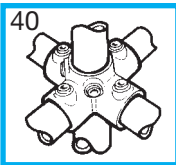
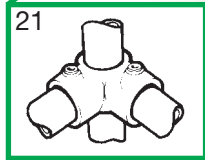
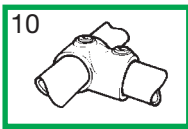
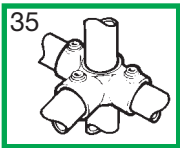

TYPE	A	B	C	D	E	F	G	H	Ø	KG
M58				35	112	51	83	52	11	0,37

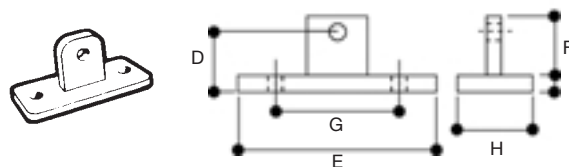

M58

Godstykkelese på lap: 12 mm.

TYPE	A	B	C	D	E	F	G	H	Ø	KG
C58-5	5									0,70
C58-6	6									0,76
C58-7	7									0,84
C58-8	8									0,94
C58-9	9									1,07

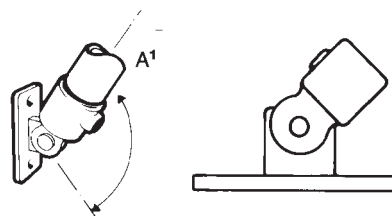

C58

TYPE	A	B	C	D	E	F	G	H	Ø	KG
59-5	5		10		81	28	19			0,11
59-6	6				87	32	26			0,12
59-7	7				98	34	33			0,20
59-8	8		14		104	52	38			0,28
59-9	9				111	47	51			0,30

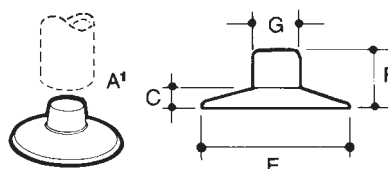

59

Aluminium

TYPE	A	B	C	D	E	F	G	H	Ø	KG
61-3	3				70	32	47	6,5	6,5	0,19
61-4	4				78	39	54	6,5	6,5	0,23
61-5	5				80	40	57	6,5	6,5	0,33
61-6	6				90	49	64	6,5	6,5	0,50
61-7	7				102	51	76	6,5	6,5	0,62
61-8	8				115	59	89	6,5	6,5	0,67
61-9	9				127	63	95	10	10	1,08

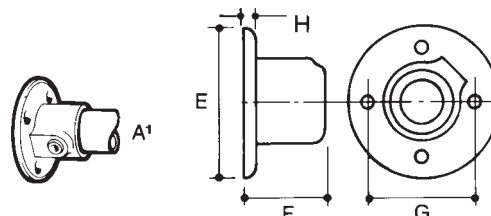

61

TYPE	A	B	C	D	E	F	G	H	Ø	KG
62-2	2			32	63	38	44	5	9	0,04
62-5	5			65	116	79	76	6	11	0,59
62-6	6			76	128	89	89	8	14	0,73
62-7	7			76	140	90	102	11	14	1,30
62-8	8			89	155	90	115	12	14	1,60
62-9	9			102	165	127	127	10	18	1,76

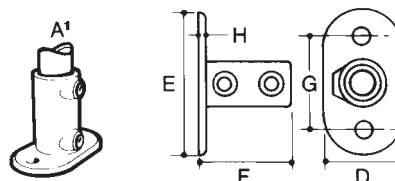

62

TYPE	A	B	C	D	E	F	G	H	Ø	KG
63-6	6			78	130	92	96	8	14	0,98
63-7	7			76	138	95	106	10	14	1,15
63-8	8			90	155	100	115	10	14	1,51

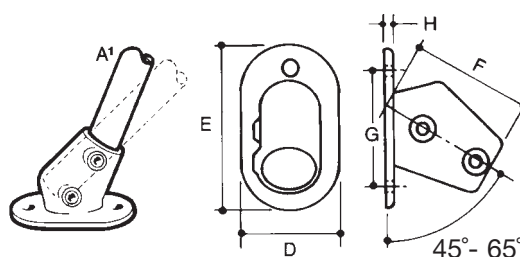

63

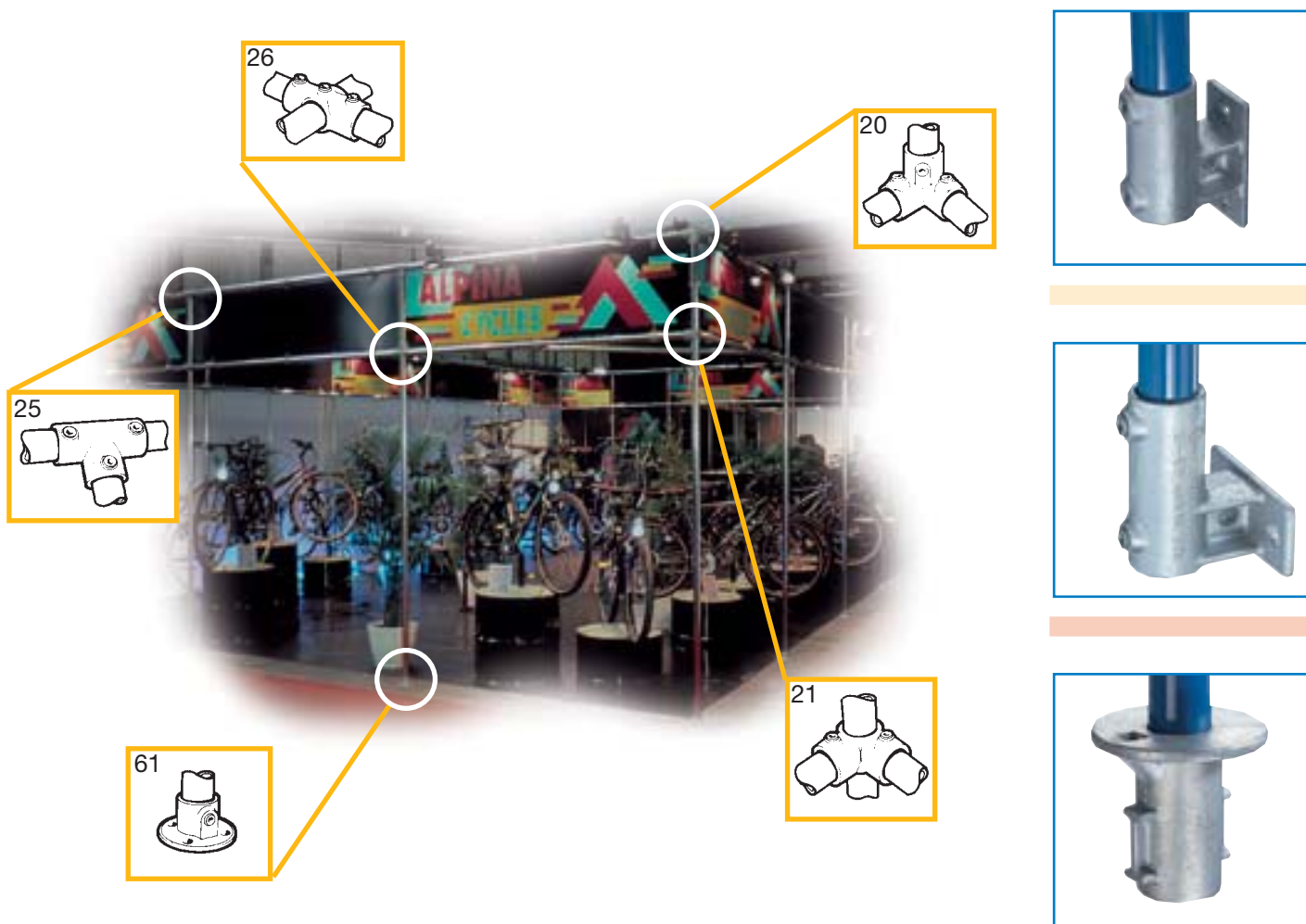

TYPE	A	B	C	D	E	F	G	H	Ø	KG
64-6	6			87	95	21	67	57	14	0,77
64-7	7			92	108	22	72	64	14	1,12
64-8	8			99	122	22	89	70	14	1,54

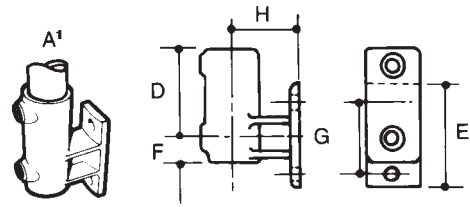

64

TYPE	A	B	C	D	E	F	G	H	Ø	KG
65-6	6			83	98	22	67	57	14	0,76

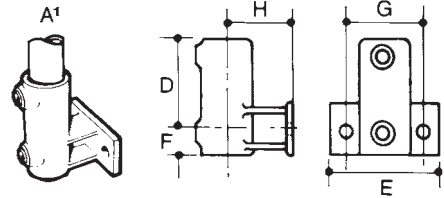

65

TYPE	A	B	C	D	E	F	G	H	Ø	KG
66-6	6			127	123	11	115			1,87
66-7	7			140	136	11	127			2,32
66-8	8			140	136	11	127			2,50

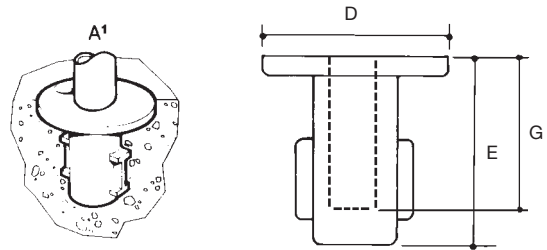

66

TYPE	A	B	C	D	E	F	G	H	Ø	KG
67-8	8			96	152	90	114	9	14	1,30

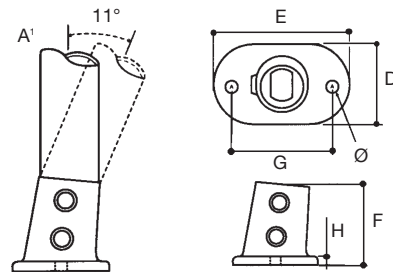

67

TYPE	A	B	C	D	E	F	G	H	Ø	KG
68-6	6			63	45	77	71	24	11	0,62
68-7	7			72	53	83	83	28	11	0,80
68-8	8			78	60	89	86	31	11	0,95

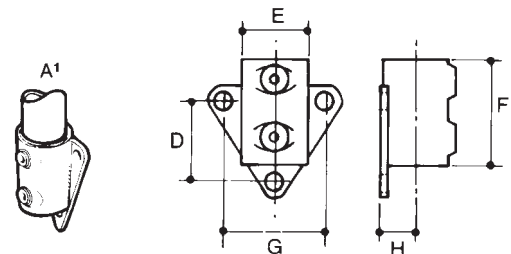

68

TYPE	A	B	C	D	E	F	G	H
69-6	6			130	75	78	95	58
69-7	7			145	80	90	97	58
69-8	8			160	90	90	112	58

TYPE	J	K	L	M	N	P	Ø	KG
69-6	15	10	100	35	7	45	11	1,72
69-7	20	10	115	40	7	47	11	1,90
69-8	29	10	130	50	7	54	11	2,30

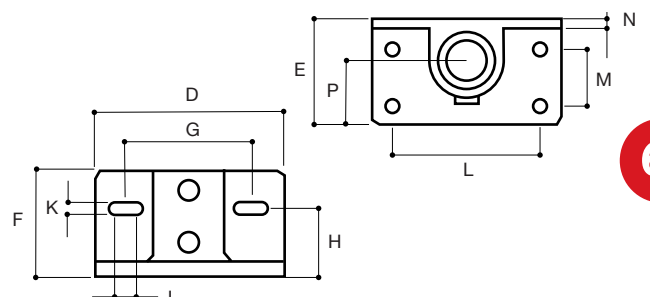

69

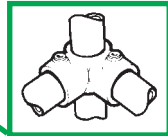
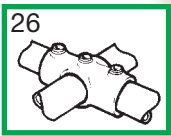
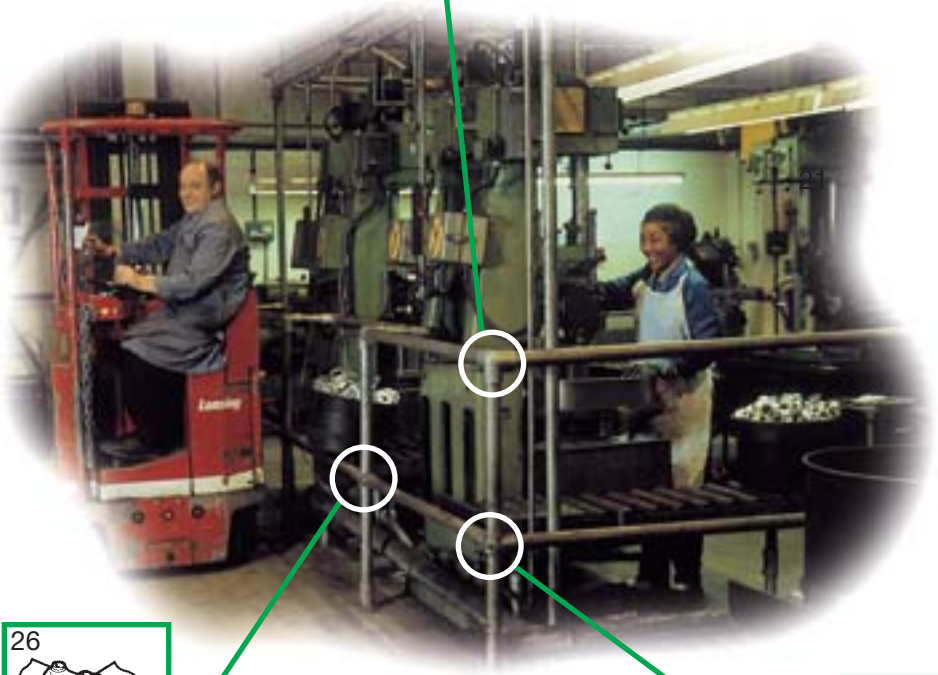
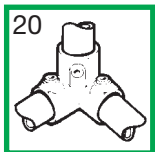
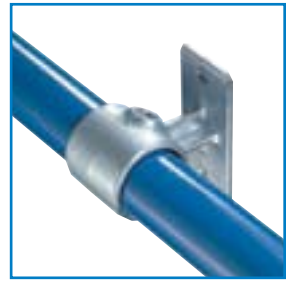
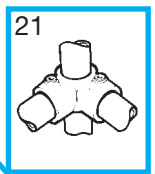
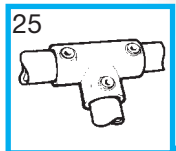
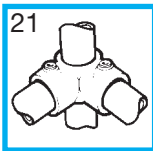
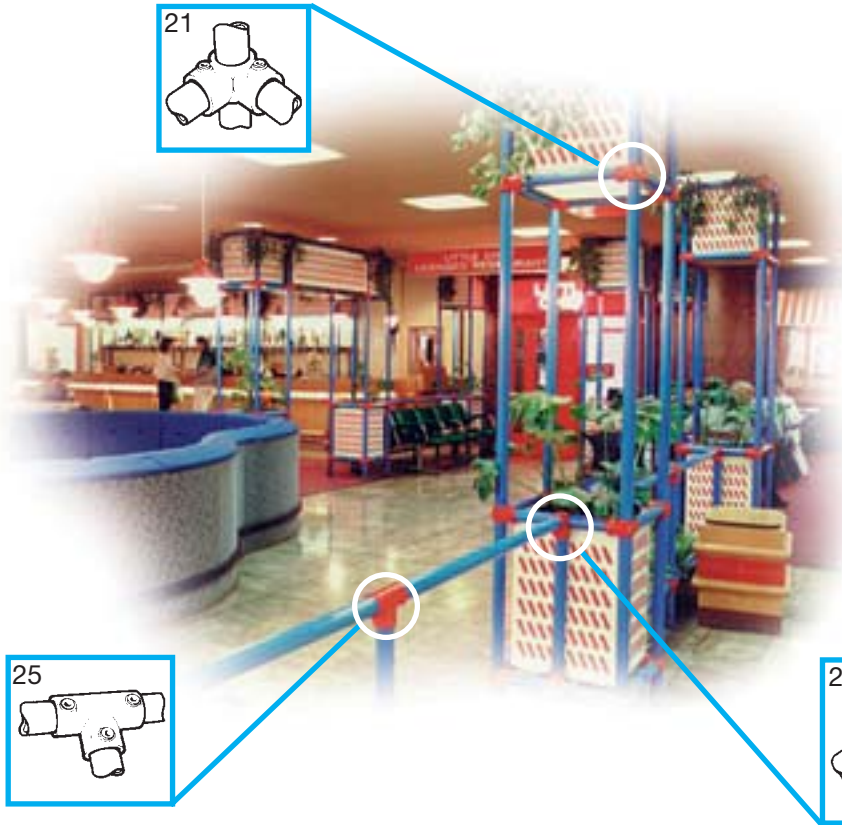

TYPE	A	B	C	D	E	F	G	H	Ø	KG
70-5	5			55	78	46	57		8	0,36
70-6	6			58	88	40	70		8	0,44
70-7	7			64	102	46	82		8	0,56
70-8	8			70	108	52	82		8	0,78

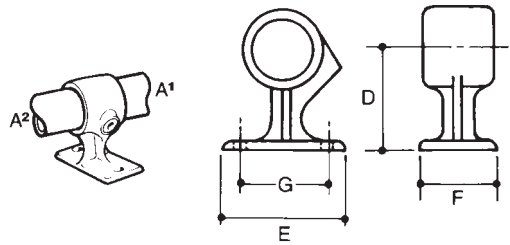

70

TYPE	A	B	C	D	E	F	G	H	Ø	KG
71-6	6			125	143	25				0,24
71-7	7			150	154	25				0,32
71-8	8			155	167	25				0,36

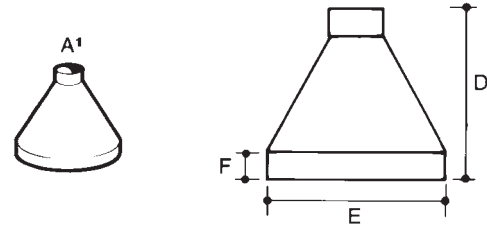

71

TYPE	A	B	C	D	E	F	G	H	Ø	KG
72-8	8			203	33	51	152	19	11	1,25

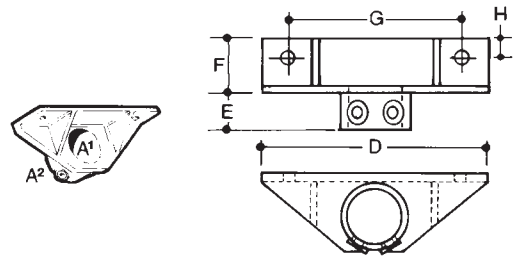

72

TYPE	A	B	C	D	E	F	G	H	Ø	KG
75-4	4				23					0,05
75-5	5				26					0,13
75-6	6				26					0,13
75-7	7				26					0,15
75-8	8				26					0,19

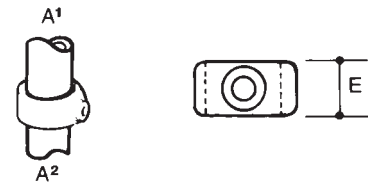

75

TYPE	A	B	C	D	E	F	G	H	Ø	KG
76-5	5			30	27	9				0,17
76-6	6			35	27	13				0,21
76-7	7			38	27	13				0,23
76-8	8			41	27	13				0,24

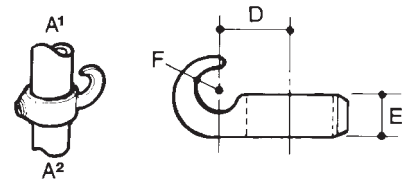

76

TYPE	A	B	C	D	E	F	G	H	Ø	KG
77-4	4									0,001
77-5	5									0,004
77-6	6									0,007
77-7	7									0,016
77-8	8									0,020
77-9	9									0,025



Grå
PLASTICPROP

77

Se også metalprop Type 84

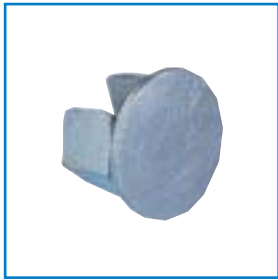
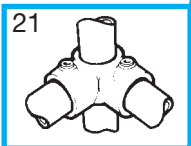
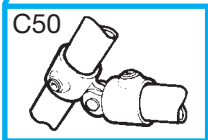
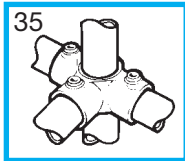
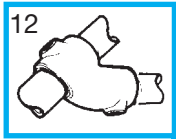
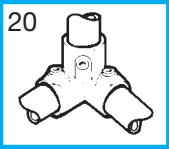
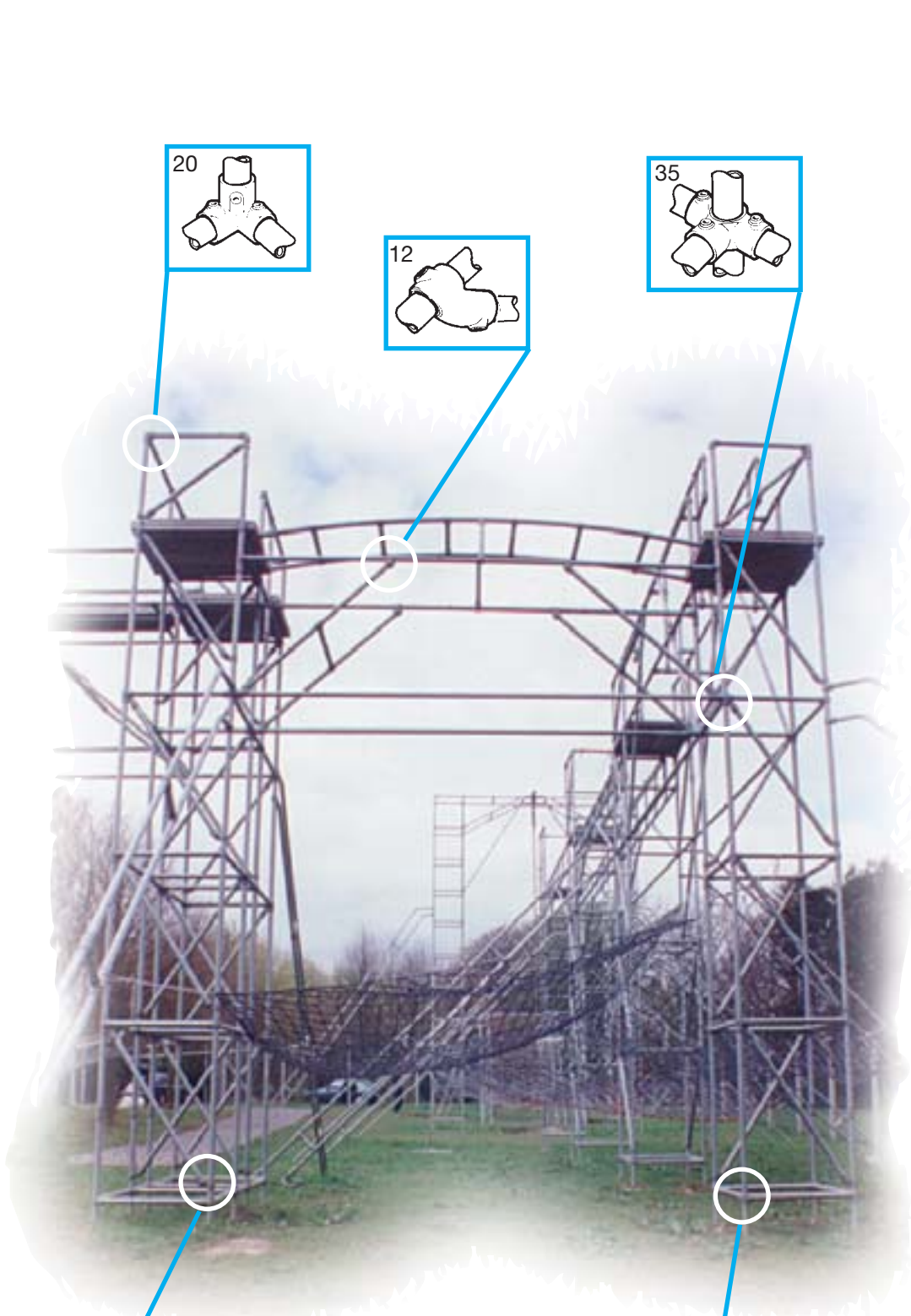

TYPE	A	B	C	D	E	F	G	H	Ø	KG
78-5	5			30	26				14	0,21
78-6	6			33	26				14	0,25
78-7	7			38	26				14	0,26
78-8	8			41	26				14	0,28

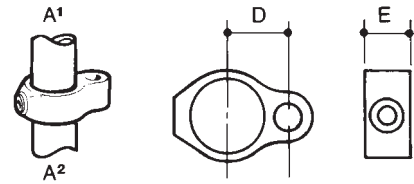

78

Til brug som hængsel, se Type 83

TYPE	A	B	C	D	E	F	G	H	Ø	KG
81-5	5			24	21	56				0,07
81-6	6			27	25	59		30		0,08
81-7	7			32	25	64				0,08
81-8	8			34	25	66				0,09
81-9	9			40	25	72				0,10

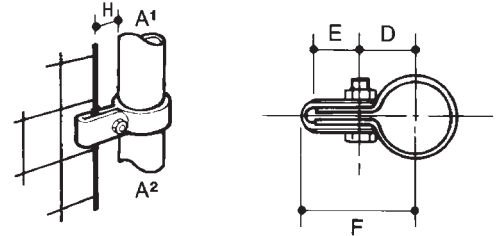

81

TYPE	A	B	C	D	E	F	G	H	Ø	KG
82-5	5			24	21	112				0,11
82-6	6			27	25	118		30		0,12
82-7	7			32	25	128				0,13
82-8	8			34	25	132				0,14
82-9	9			40	25	144				0,14

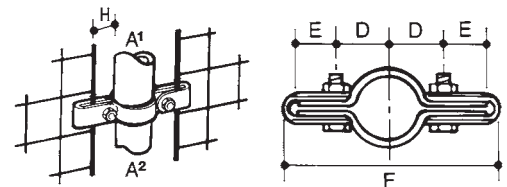

82

TYPE	A	B	C	D	E	F	G	H	Ø	KG
83-5	5			30	26	38		13		0,20
83-6	6			33	26	38		13		0,25
83-7	7			38	26	38		13		0,29
83-8	8			41	26	38		13		0,30

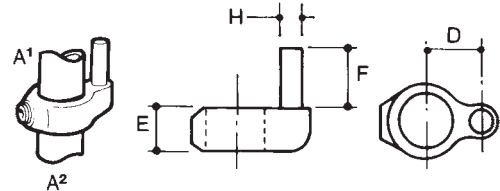

83

Til brug som hængsel, se Type 78

TYPE	A	B	C	D	E	F	G	H	Ø	KG
84-5	5									0,05
84-6	6									0,10
84-7	7									0,12
84-8	8									0,17
84-9	9									0,29

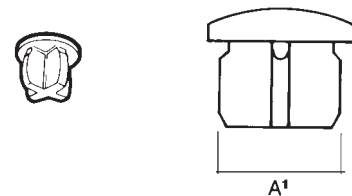

84

Se også plasticprop type 77

TYPE	A	B	C	D	E	F	G	H	Ø	KG
86-8	8			68						0,76

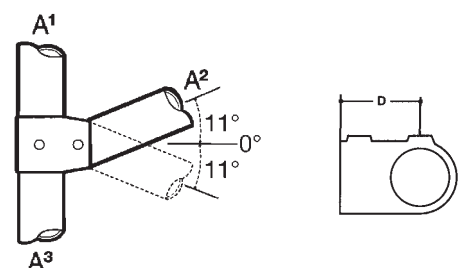

86

Til gelænder ved stigninger eller fald op til 11°

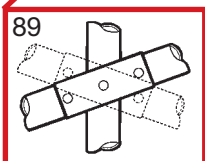
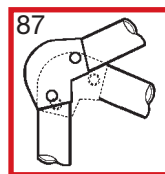
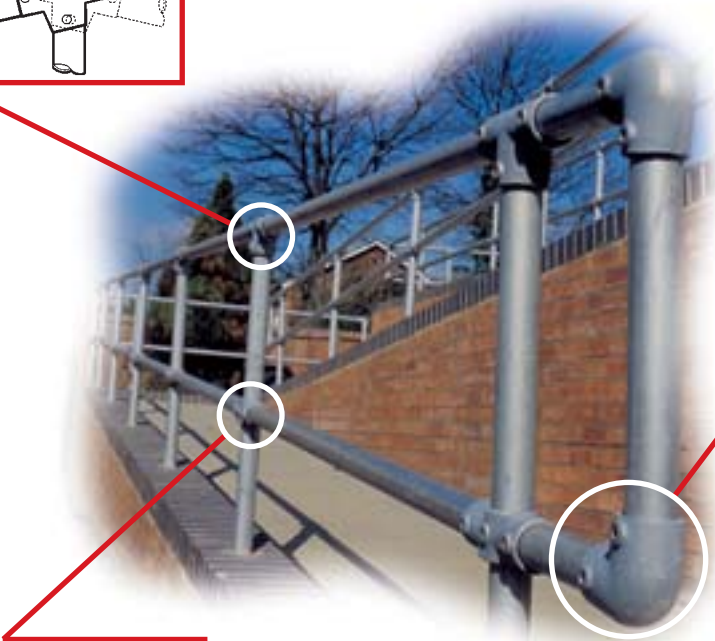
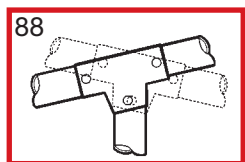
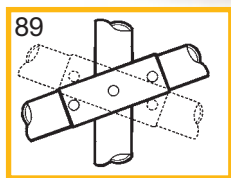
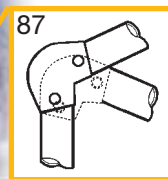
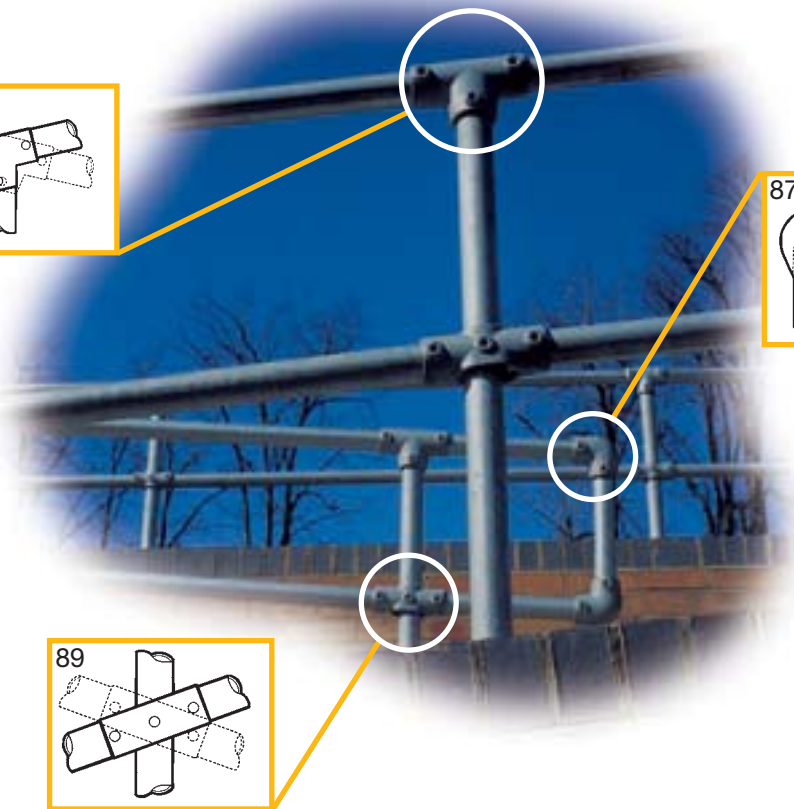
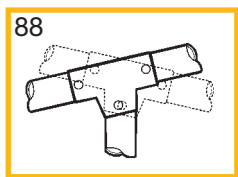

TYPE	A	B	C	D	E	F	G	H	Ø	KG
87-8	8			68						0,90

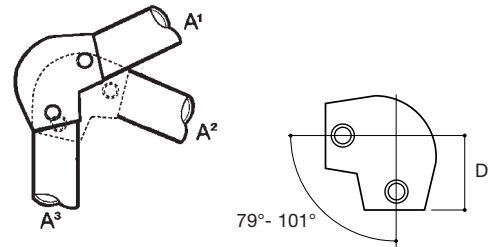
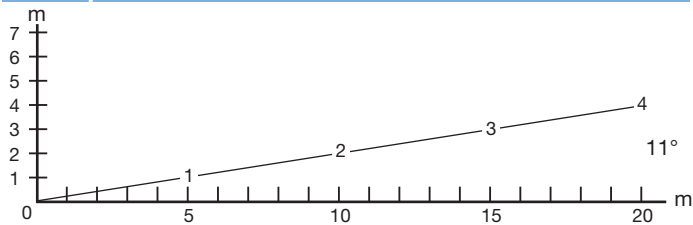

87

TYPE	A	B	C	D	E	F	G	H	Ø	KG
88-8	8			68	158					1,24

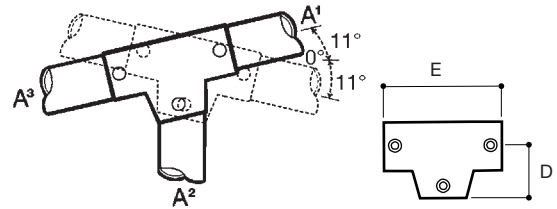

88

TYPE	A	B	C	D	E	F	G	H	Ø	KG
89-8	8				158					0,93

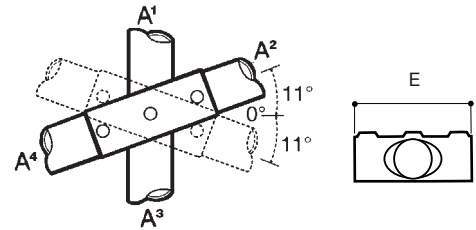

89

TYPE	A	B	C	D	E	F	G	H	Ø	KG
97-2				5/16" BSF						0,002
97-3				5/16" BSF						0,002
97-4				3/8" BSF						0,003
97-5-6				1/4" BSP						0,007
97-7-8-9				3/8" BSP						0,011



97

TYPE	A	B	C	D	E	F	G	H	Ø	KG
98		skralde					3/8"			0,24
98-5-6		top					1/4"			0,05
98-7-8-9		top					5/16"			0,05

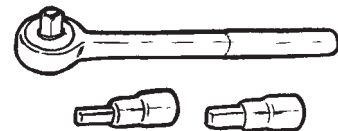

98

TYPE	A	B	C	D	E	F	G	H	Ø	KG
99-2-3			5/32	across flats						0,01
99-4			3/16	across flats						0,02
99-5-6			1/4	across flats						0,03
99-7-8-9			5/16	across flats						0,05

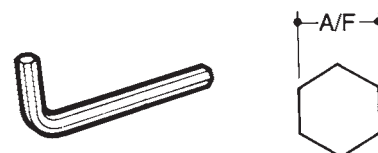

99

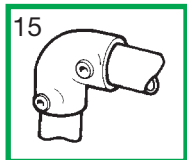

Bukket rør

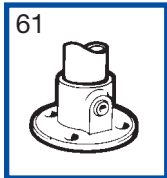
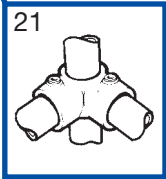
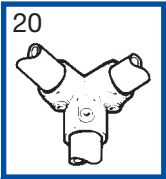
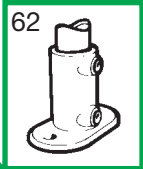
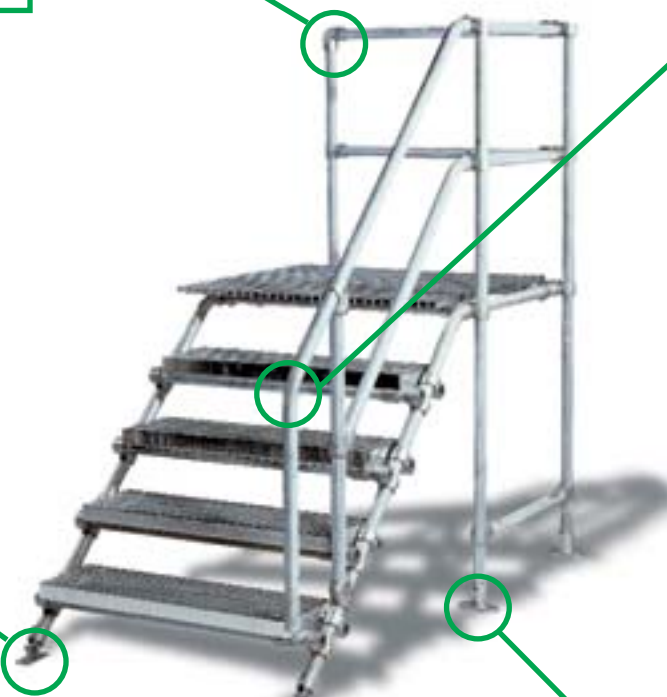
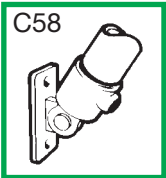

TYPE	A	B	C	D	E	F	G	H	Ø	KG
114-2	2			11	13	21				0,02
114-6	6			21	34	29				0,36
114-7	7			26	42	36				0,54
114-8	8			29	49	41				0,64

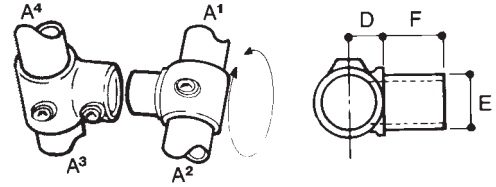

114

TYPE	A	B	C	D	E	F	G	H	Ø	KG
121-7	7			46	72	49				0,92

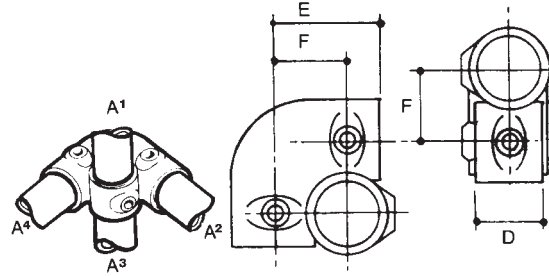

121

TYPE	A	B	C	D	E	F	G	H	Ø	KG
130-87	8	7								2,8

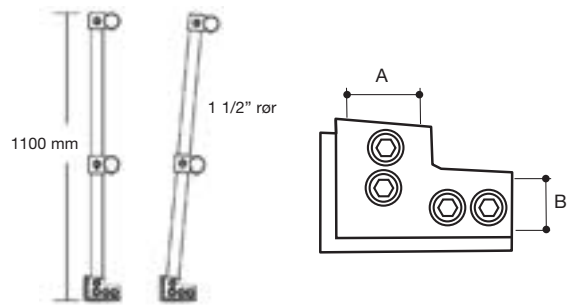

130

TYPE	A	B	C	D	E	F	G	H	Ø	KG
140-7	216	305								15,5

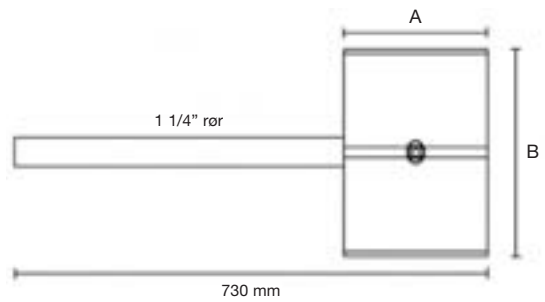

140

TYPE	A	B	C	D	E	F	G	H	Ø	KG
145-7	7			46	102	49				0,83

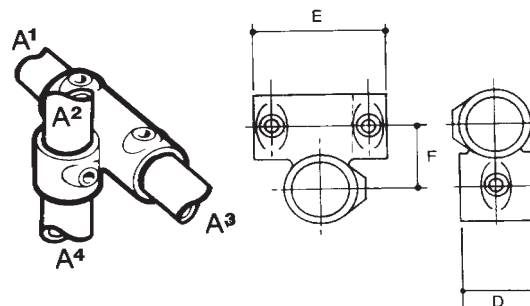

145

TYPE	A	B	C	D	E	F	G	H	Ø	KG
350-8	8			83	42	47	67	60		1,19

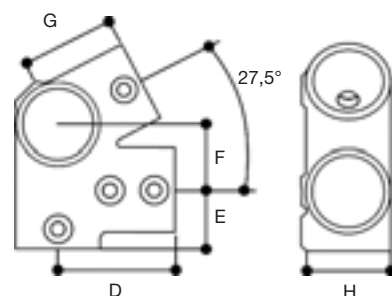

350

NOTER:



TYPE	A	B	C	D	E	F	G	H	Ø	KG
351-8	8			89	67	60				0,96

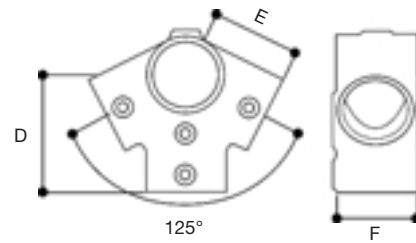

351

TYPE	A	B	C	D	E	F	G	H	Ø	KG
385-3				Gods 20x1						5 0,012
385-4				Gods 20x1						5 0,020
385-5				Gods 20x1						5 0,022
385-6				Gods 20x1						5 0,025
385-7				Gods 20x1						5 0,030
385-8				Gods 20x1						5 0,034
385-9				Gods 20x1						5 0,042

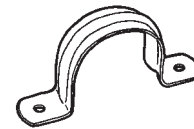

385

TYPE	A	B	C	D	E	F	G	H	Ø	KG
390-3				Gods 20x1,25						9 0,017
390-4				Gods 20x1,25						9 0,021
390-5				Gods 20x1,25						9 0,026
390-6				Gods 20x1,25						9 0,030
390-7				Gods 20x1,25						9 0,035
390-8				Gods 20x1,25						9 0,039
390-9				Gods 20x1,25						9 0,041



390

TYPE	A	B	C	D	E	F	G	H	Ø	KG
391-6				Gods 25x4						0,116

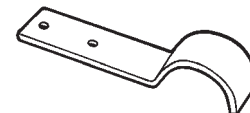

391

ADD ON FITTINGS

“ADD ON FITTINGS” er designet og beregnet til brug ved eksisterende konstruktion, således at en udbygning er mulig uden at man skal skille konstruktionen ad.

TYPE	A	B	C	D	E	F	G	H	Ø	KG
A10-7	7			60	28					0,57
A10-8	8			88	33					0,86

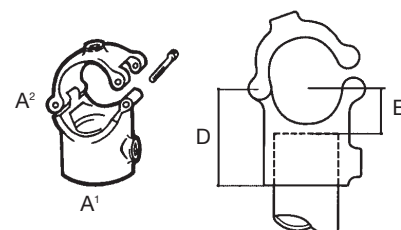

A10

NOTER:



TYPE	A	B	C	D	E	F	G	H	Ø	KG
A12-8	8			60	122	52				1,07

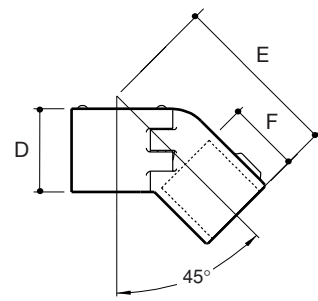

A12

TYPE	A	B	C	D	E	F	G	H	Ø	KG
A21-8	8			88	60	55				1,07

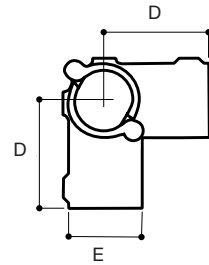

A21

TYPE	A	B	C	D	E	F	G	H	Ø	KG
A26-8	8			88	60	55				1,07

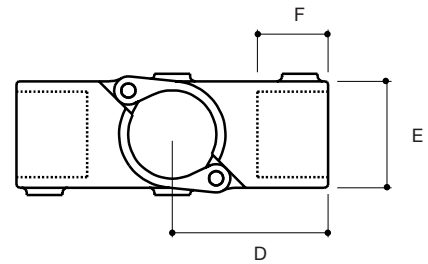

A26

TYPE	A	B	C	D	E	F	G	H	Ø	KG
A35-8	8			60	176	55	88			1,57

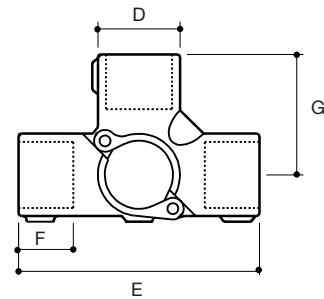

A35

TYPE	A	B	C	D	E	F	G	H	Ø	KG
A40-8	8			60	88	55				1,96

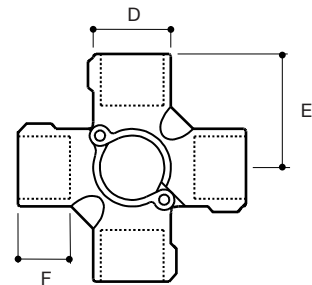

A40

TYPE	A	B	C	D	E	F	G	H	Ø	KG
A45-7	7			49	46					0,65
A45-8	8			55	51					0,79

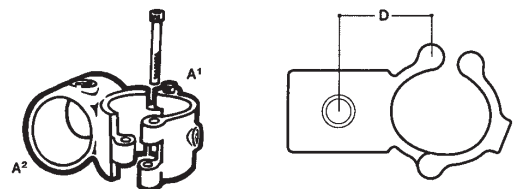

A45

Free Standing Roof Edge Protection System



**Sikkerhedsgelænder
til tage**



**Undgå
montage/fastgørelse
i eksisterende tag**

**Tilpasses efter
forhold /
niveauforskelle**



Ring efter specialbrochure